

Hydraulic Driven FMH

BOOK: HYD-010
DATE: April 1, 2013

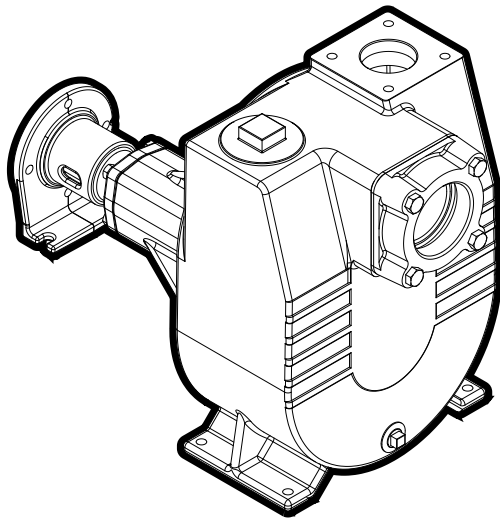

Features:

- **Volute:** Cast iron rugged construction with tapped openings provided for priming, venting and draining.
- **Impeller:** Semi open cast iron, non clogging, designed for water but capable of mud, sand and silt up to 10% by volume.
- **Mechanical Seal:** Standard carbon/ceramic faces, Viton® elastomers, 300 series stainless components.
- **Bearing Frame:** For hydraulic drive with heavy sealed bearings and a keyed stainless shaft and replaceable wear plate for maintaining maximum efficiency.
- **Mounting:** Horizontal position.
 - B-Fit 7/8" hydraulic spline shaft

Applications:

- Irrigation
- Construction
- Mining
- Commercial
- Municipal
- Light Industrial
- Water Truck

Viton® is a registered trademarks of E. I. du Pont de Nemours and Company.

Specifications:

Capacities: to 760 gpm

Heads: to 145 feet

Working Pressure: 120 psi max

Temperature: 212 °F max

Rotation: clockwise viewed from motor end

Pipe Connections: NPT

Discharge	Suction
4"	4"

Hydraulic Driven FMIH

Dimensional Drawings:

Note:
Dimensions are for estimating purposes only. All dimensions in inches.

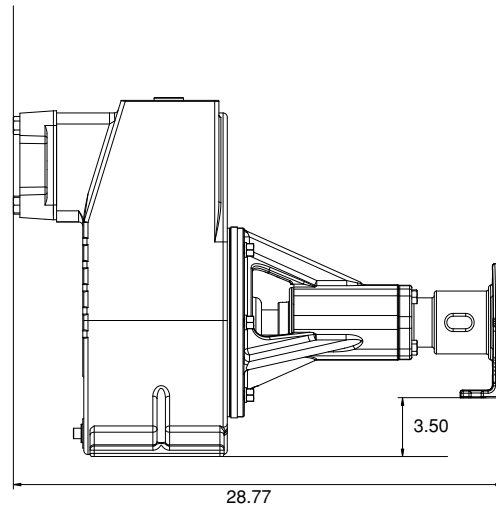
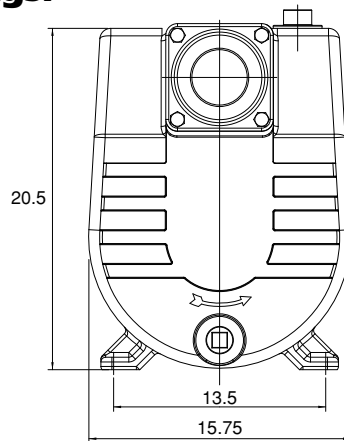

Ordering Information:

Hydraulic Driven MIT-40			
Pump Size (Dis. x Suc.)	Model Description	Order Number	Weight
4 x 4	FMIH-40	90295004	282

Note: All weight in pounds.

Fig No.	Part Description	FMIH-40	Materials of Construction
1	Pump Case	305455003	Cast Iron, ASTM-A48 CL30
2	Impeller	305455006	Cast Iron, ASTM-A48 CL30
3	Seal Plate	305454009	Cast Iron, ASTM-A48 CL30
5	Shaft	305454015	7M-212SST
16	Ball Bearing (2-pack)	305463036	Misc.
27	Hydraulic Adapter	305455017	Cast Iron, ASTM-A48 CL30
28	Coupling	305455016	C1045 Carbon Steel
29	Set Screw (2-pack)	305463198	Zinc Plated Steel
35	Shaft Key	305454017	1018 CRS
38	Bearing Nut	305463039	300 Series Stainless
39	Bearing Lockwasher	305463042	Zinc Plated Steel
71	Wear Plate	305455009	Cast Iron, ASTM-A48 CL30
72	Check Valve	305454020	Cast Iron, ASTM-A48 CL30
73A	Top Weight - Check Valve	305454023	Cast Iron, ASTM-A48 CL30
73B	Bottom Weight - Check Valve	305454025	Cast Iron, ASTM-A48 CL30
79	Transmission Head	305454033	Cast Iron, ASTM-A48 CL30
81	Seal Cover	305454039	Cast Iron, ASTM-A48 CL30
90	Mechanical Shaft Seal	305463044	Carbon/Ceramic Viton®/316SS
100A	Case Gasket	305454042	NA60
100B	Flapper Valve	305454045	Neoprene
500A	Pipe Plug 3"	305463197	CAD Plated Steel
500B	Pipe Plug 3/4" (3-pack)	305463050	CAD Plated Steel
Not Shown	Pipe Plug 4"	305463076	CAD Plated Steel
510	Impeller Hex Bolt	305463078	300 Series Stainless
520	Impeller Washer	305455015	1018 CRS
530A	Wear Plate Bolts (6-pack)	305463079	Zinc Plated Steel
530B	Flapper Bolt	305463081	300 Series Stainless Steel
530C	Hex Nuts (6-pack)	305463059	Zinc Plated Steel
530E	Nut, Flapper	305463083	Zinc Plated Steel
530F	Valve Hex Capscrew (4-pack)	305463086	Zinc Plated Steel
530G	Washer Bearing Cover (6-pack)	305463067	Zinc Plated Steel
530H	Bolt - Bearing Cover (4-pack)	305463069	Zinc Plated Steel
531	Threaded Stud - Transmission (6-pack)	305463199	Zinc Plated Steel
532	Set Screw (2-pack)	305463075	Zinc Plated Steel
532	Set Screw	305463075	Zinc Plated Steel

Viton® is a registered trademarks of E. I. du Pont de Nemours and Company.

Hydraulic Driven FMH

Performance Curve:

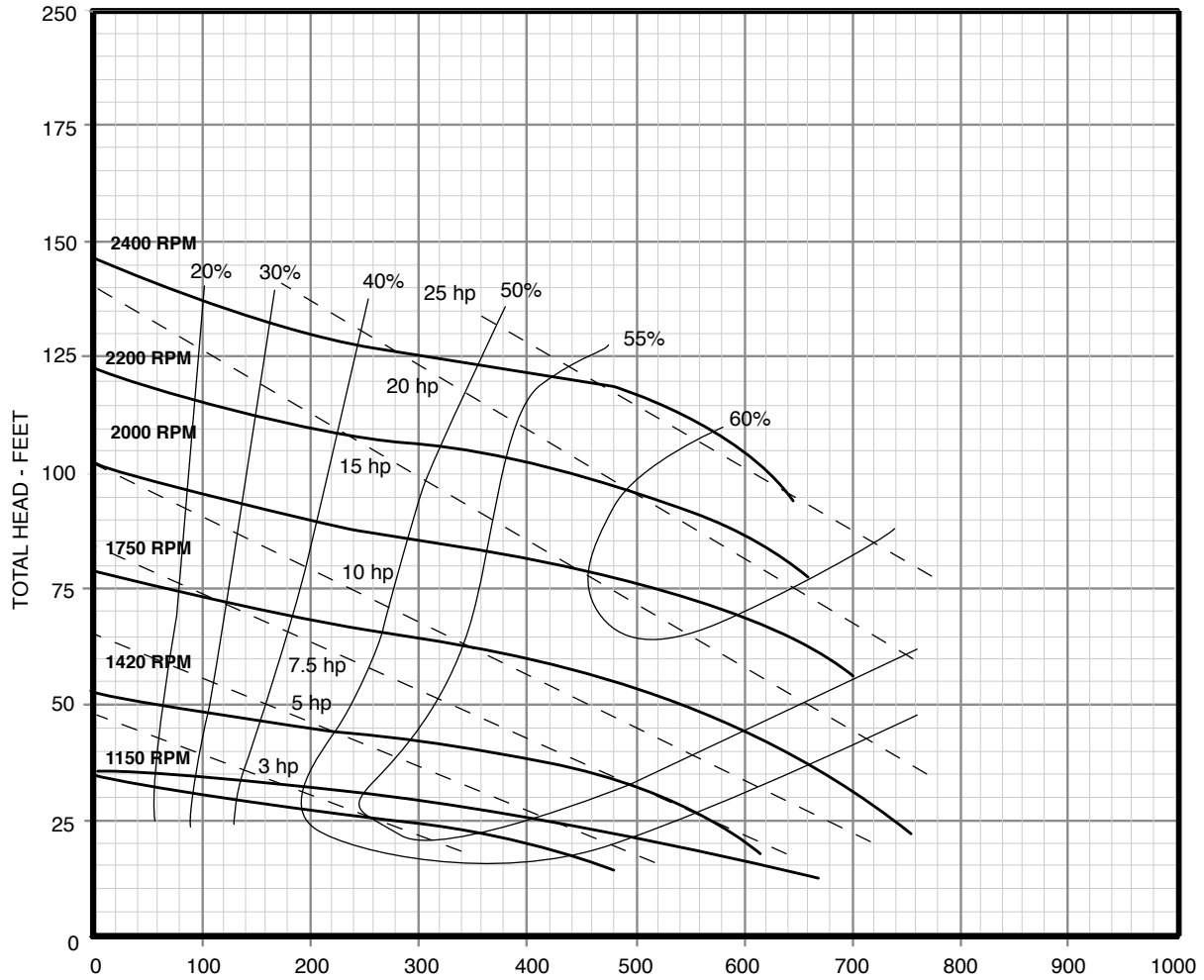

FLOWRATE U.S. GALLONS PER MINUTE

IMPELLER DIA: 8.718"
 SPEED: Various
 SOLIDS: 2"

